

CONTENTS

Blow Ceiling Mount

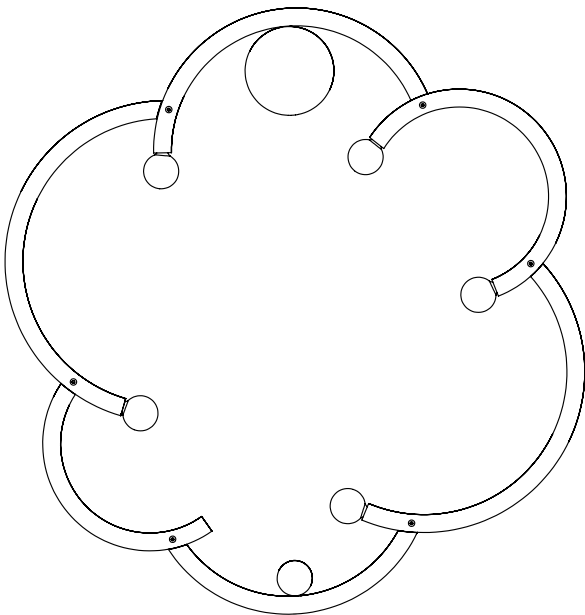

8-32 Screws (2)



Bulbs (5)

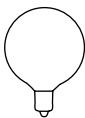

Incandescent 25-Watt

4" Drywall Screw



Drywall Anchor



SAFETY INFORMATION

Only one light bulb per socket.
Only suitable for direct mounting on non-combustible surfaces.
Under no circumstances can Blow Fixtures be mounted on normally flammable surfaces.
Suitable for dry, indoor use only.
Maximum ambient temperatures: 25° C

BLOW CEILING MOUNT INSTALLATION

Note: Please contact a licensed electrician.

Note: Do not use bulbs that exceed 25 watts.

1. Attach large barrel mount (A) to junction box (B) by screwing provided 8-32 screws from inside barrel to junction box.
2. Mark point to attach small barrel mount (C) 28.4 inches from center of large barrel. Attach small barrel to ceiling using a 3" drywall screw or anchor through the center hole (D).
2. Attach fixture to barrels using provided screws through mounting discs.
3. Connect wires and tuck inside barrels. Thread on ceiling mount caps (E).
4. Screw in light bulbs once fixture is secure.

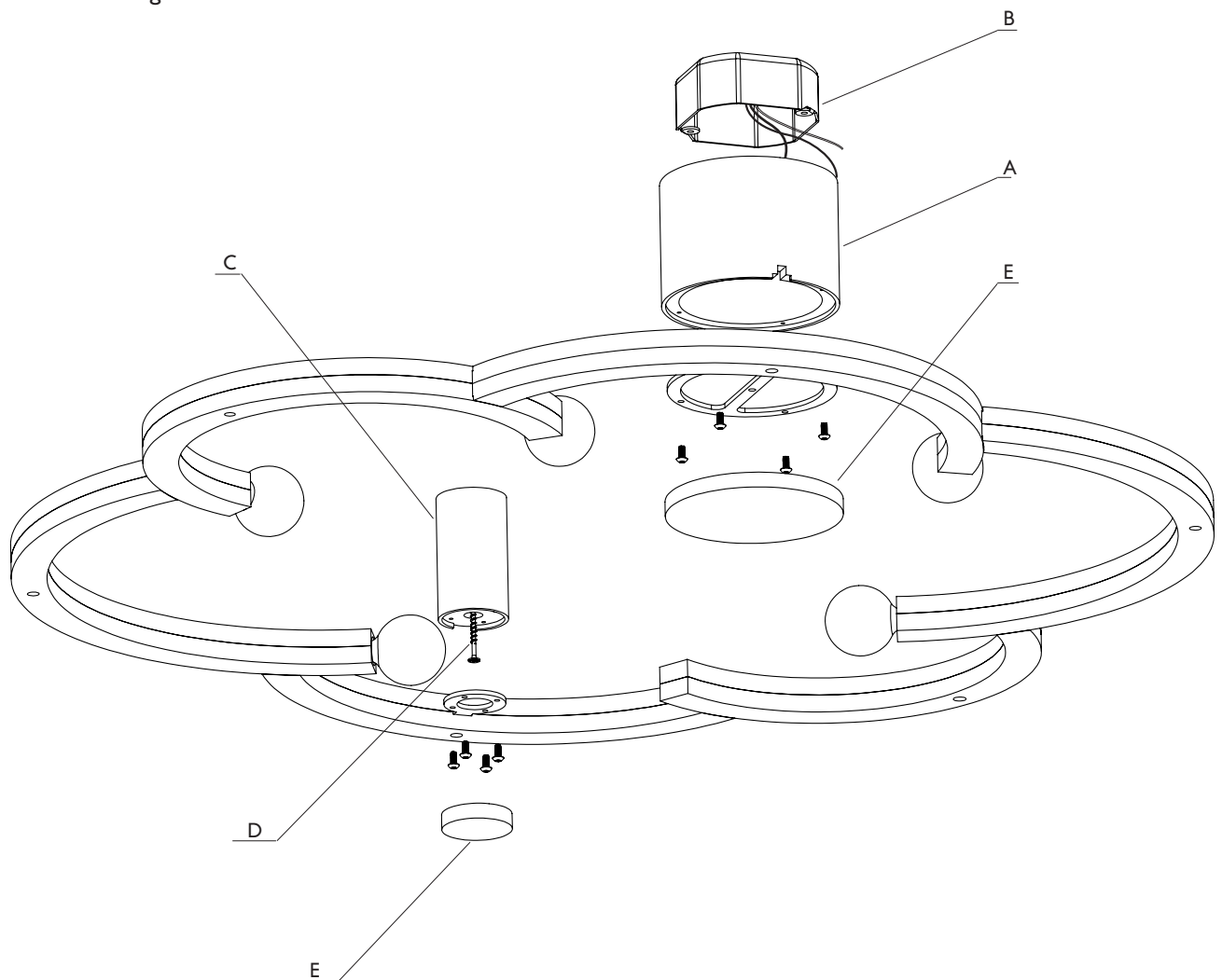

BLOW CEILING MOUNT INSTALLATION

